

# **Biodrier** Executive Hand dryer



**High Speed**

# Surface Mounted High Speed Hand Dryer

## Operating Instructions and Parts Manual

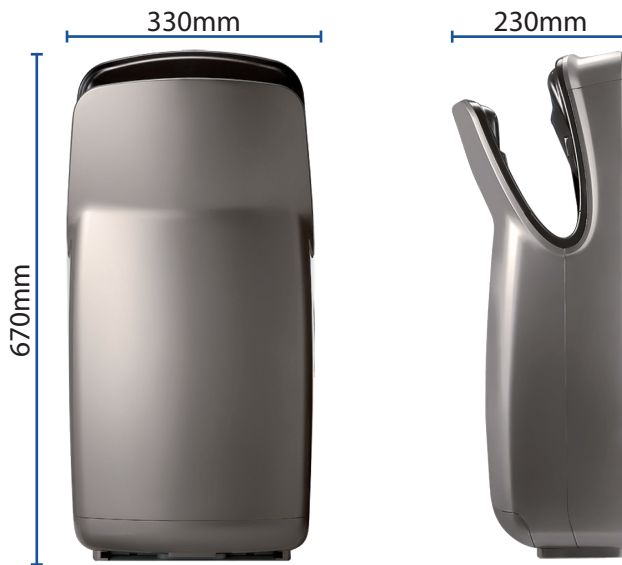

### Technical Specifications

Item Category	Performance Data
Operating Voltage	220 - 240Vac, 50-60 Hz, 700 - 1200 WATTS
Warm Air Speed Output	150 m/s @ 1200 WATTS
Display	LED instructions and countdown
Motor Type	35,000 rpm, 2 speed adjustable motor
Motor Thermal Protection	Auto Resetting Thermostat turns unit off, 240V at 239°F (115°C)
Noise Level	58 - 80 dba @ 1 meter
Water Tank	LED indicator when tank is full
Filter Sensor	LED indicator when filter is full
Air Purification	Enzyme HEPA Filter H13 - simple cartridge replacement system
Air Freshener	Organic moisturiser, sanitizer, air freshener with ocean breeze fragrance
Water Tank & Filter Security	Sliding locking system, lock both with one touch
Drying Time	Under 10 seconds
Circuit Operation	Infrared Automatic, self adjusting
Timing Protection	20 seconds auto shut off
Drip Proof	IP33
Isolation	CLASS II
Certificates	CE, GS, ETL, WEEE, Greenspec
Net Weight	9 kg
Shipping Weight	10 kg
Unit Size	330mm W x 670mm H x 230mm D
Item Code	Cover Type/Finish
BE1000W	Fire proof ABS, 94VO, PC, PMMA, UV Coated - White
BE1000S	Fire proof ABS, 94VO, PC, PMMA, UV Coated - Silver
BE1000B	Fire proof ABS, 94VO, PC, PMMA, UV Coated - Blue
BE1000G	Fire proof ABS, 94VO, PC, PMMA, UV Coated - Gold

# Surface Mounted High Speed Hand Dryer

## Operating Instructions and Parts Manual

### General Safety Information

#### **⚠ WARNING**

This product is intended for installation by a qualified service person. Use AWAG No.16 solid conductor for wiring.

Failure to properly ground unit could result in electrical shock and/or death.

Disconnect power at the service breaker before installing or servicing.

NOT FOR HOUSEHOLD USE - MAY CAUSE BURNS  
"IMPROPRE A L'USAGE DOMESTIQUE - PUET  
OCCASIONNER."

NOTE: Do not install dryer over wash basin.

Type Y attachment

If the power supply cord is damaged, it must be replaced by the manufacturer or its service agent or a similar qualified person in order to avoid a hazard.

Means for disconnection must be incorporated in the fixed wiring in accordance with the wiring rules.

### Installation

#### **Installation must be carried out only by a qualified electrician**

1. Make sure power supply breaker is switched off. Installation must be carried out in accordance with the current edition of the local wiring regulations code having jurisdiction. Installation should be performed only by a qualified electrician.

2. Place template against wall at desired height (see mounting height recommendations) and mark locations of 4 mounting holes and wire service entry at knockout (KO) location.

**NOTE:** For two or more dryers, dryers should be no closer than 24 inches (610 mm) on centre.

3. Connect supply wires to terminal block where indicated and connect ground wire to baseplate with ground screw.

#### **Connections:**

##### **A Type: Power cable not equipped**

1. Secure the line and connect the power cable into the

proper terminal block locations. Verify connections are correct before proceeding.

2. Cover the power connector with the provided housing cover (Power Supply Cover Kit)

Minimum wire cross section: 2x1mm<sup>2</sup>

##### **B Type: Power cable equipped**

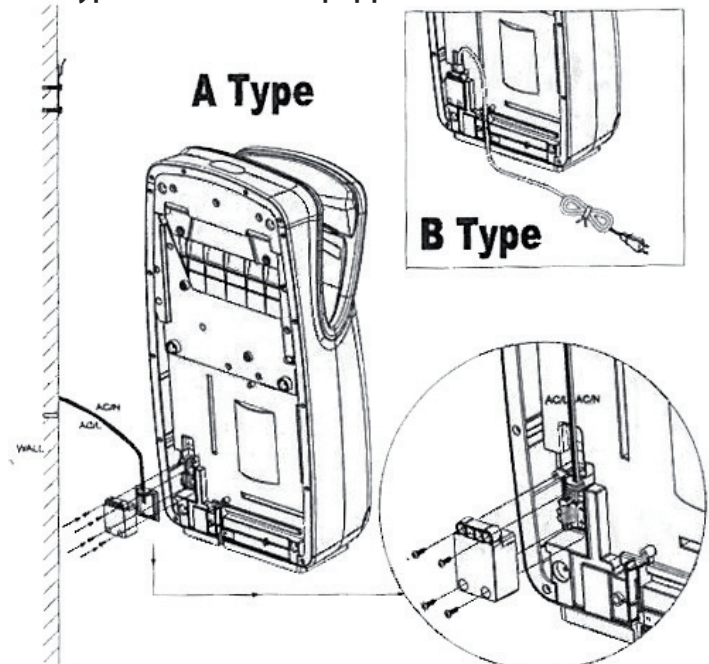

# Surface Mounted High Speed Hand Dryer

## Operating Instructions and Parts Manual

### Recommended Mounting Heights

From floor to bottom of dryer.

Men's	Ladies	Children, ages 11-17	Children, ages 3-10	Disabled
13"	11"	10"	6"	4"
350 mm	300 mm	250 mm	150 mm	100 mm

### Consumables

#### Biodrier Anti Bacterial HEPA Filter

The Anti Bacterial Filter is fitted to ensure dust and airborne bacteria is restricted from entering the internal components and airflow of the dryer. The filter should be replaced every 3-6 months, depending on usage.

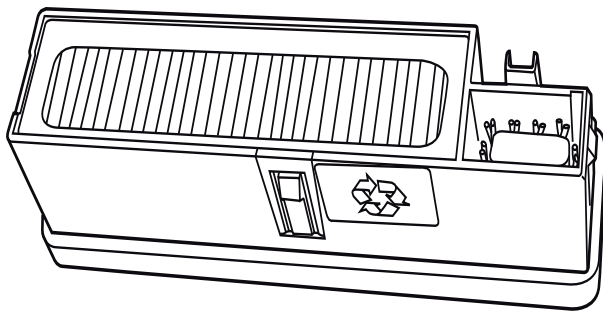

Product	Order Code
Antibacterial HEPA filter	HD-EXEC-HEPA-FILTER
Moisturising Gel	HDC-BE1000GELS

#### Biodrier Gels

Biodrier Gels are manufactured exclusively for Biodrier and preforms 3 jobs in one:

1. Moisturise the hands.
2. Sanitise the product internally, and the users hands.
3. Fragrances the surrounding washroom area whilst in use.

The Gels are manufactured from natural sources and are chemical free.



### Operation

Stand By Mode	LED-5 Green light ON
Operating Mode	LED-5 Blue Light ON & LED-1 to 4 pulse in sequence and then together twice
Water Tank Full	LED-7 Blue Light ON
After Tank is Emptied	LED-7 Light OFF
Change Filter	LED-6 Light ON
After Filter Change	LED-6 Light OFF

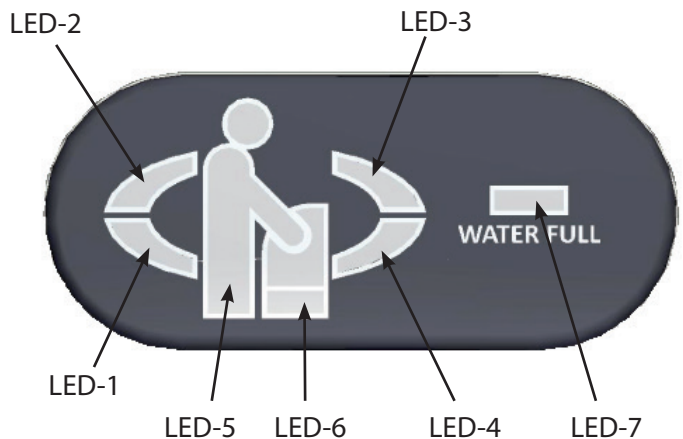

# Surface Mounted High Speed Hand Dryer

## Operating Instructions and Parts Manual

### Cleaning and Maintenance Instructions

Periodic cleaning of the unit is recommended to ensure optimum performance.

- Switch to service mode located internally, above the water tank.
- Wipe the cover with a soft cloth and a mild cleaning solution. Do not Soak. Never use abrasives to clean the cover.

#### **WARNING**

- Never spray water directly onto hand dryer
- Never use any abrasives or harsh chemicals
- Turn off electricity prior to cleaning the hand dryer

7. Wipe down the external surfaces of the Biodrier Executive hand dryer with a soft cloth. Switch power back on and test operation.

1. Pour a cup of water down drain hole. Use cleaning brush supplied to clean drain hole.

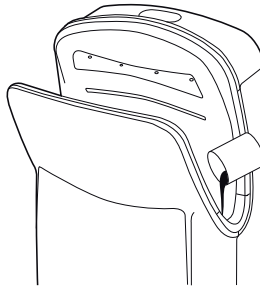

2. Unlock the drip tray.

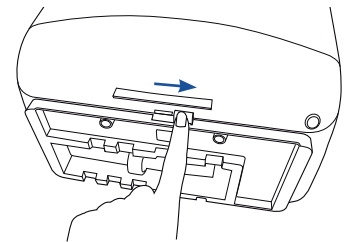

6. Disassemble drain tank and rinse clean using a disinfectant, then replace.

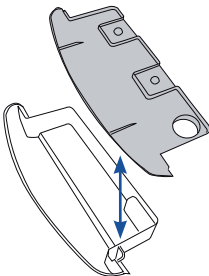

3. Remove drain tank and empty.

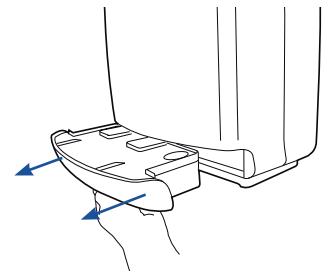

5. Clean filter casing by wiping with soft damp cloth. Replace the antibacterial filter every 3 months, or when LED 6 illuminates. Moisturising gels should be replaced every month. Slide filter back into place.

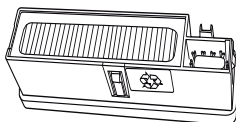

4. Remove filter.

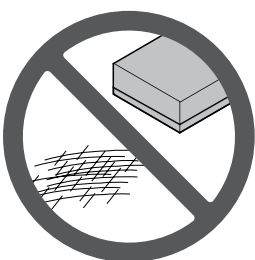
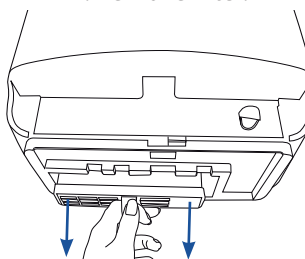

# Surface Mounted High Speed Hand Dryer

## Operating Instructions and Parts Manual

### Diagram

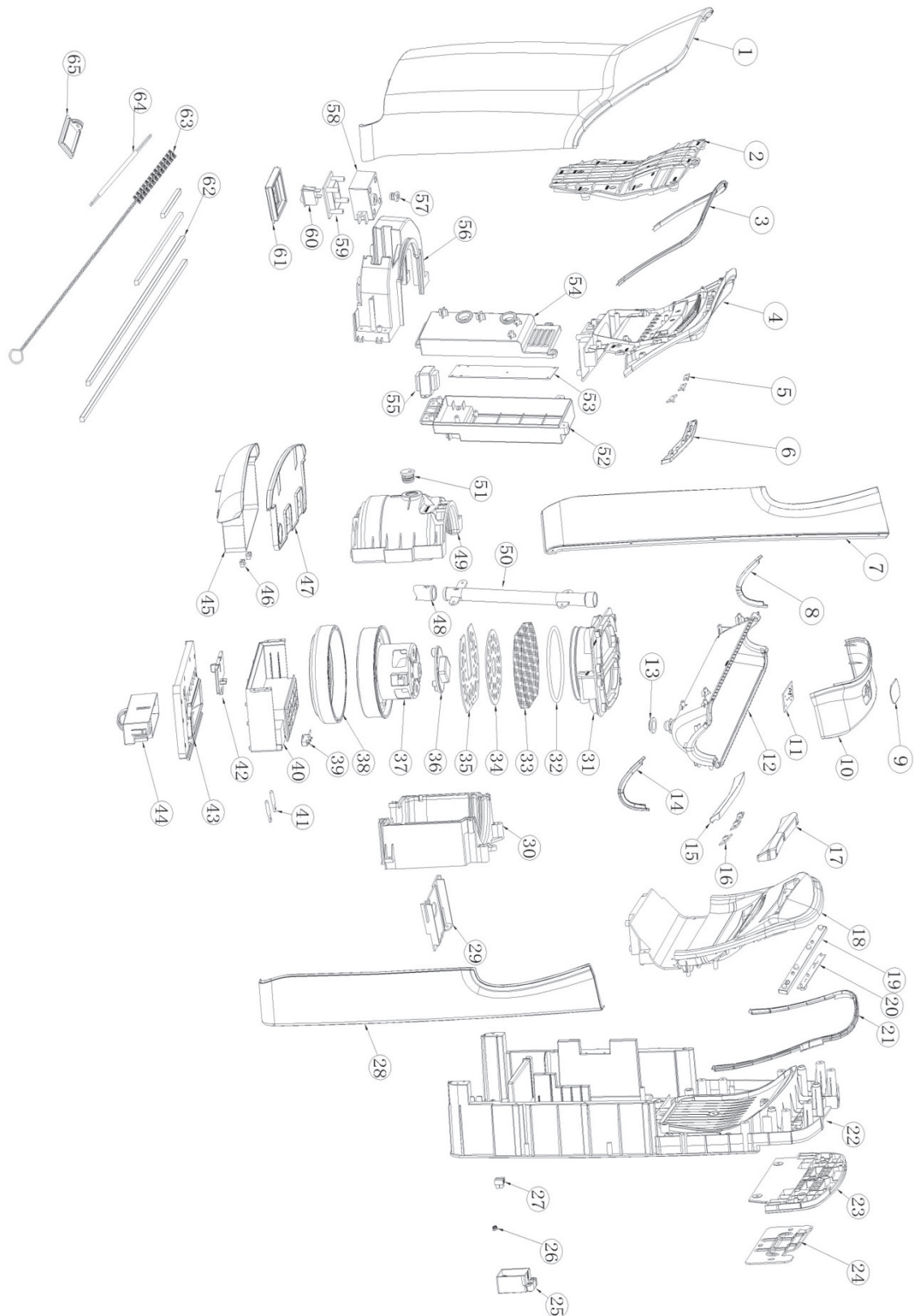

# Surface Mounted High Speed Hand Dryer

## Operating Instructions and Parts Manual

### Parts List

Key	Description
1	Cover front
2	Duct front
3	Silica gel
4	Cover hand front
5	PCB board
6	Cover window front
7	Cover side L
8	Silica gel
9	Cover LED
10	Cover top
11	PCB board
12	Cover hand bottom
13	Silica gel
14	Silica gel
15	Cover window back
16	PCB board
17	Cover window LED
18	Cover hand back
19	Cover LED
20	PCB board
21	Silica gel
22	Cover main
23	Cover back
24	Bracket
25	Power supply cover
26	Cushion
27	Connection
28	Cover side R
29	Tube panel
30	Housing motor lower
31	Distributor air
32	Ring
33	Sponge

Key	Description
34	Round Sheet
35	Sheet
36	Fixture
37	Motor
38	Air proof sheath
39	Switch
40	Grill guide
41	Pole
42	Sheft panel
43	Filter support
44	Filter Ass'y
45	Bucket slop bottom
46	Connector panel
47	Bucket slop top
48	Tube
49	Housing motor upper
50	Water tube
51	Silica gel
52	PCB enclosure lower
53	PCB main
54	PCB enclosure lower
55	Transformer
56	Cover air tight
57	COB
58	Switch enclosure
59	Switch holder
60	Power switch
61	Silica gel
62	Silica gel (A B C D)
63	Cleaner
64	Internal wire to PCB
65	Silica gel pad



FW3 LTD, Biodrier  
West Hill, Exeter, EX11 1LQ  
tel: +44(0)1404 814292 • email: [sales@biodrier.com](mailto:sales@biodrier.com)